

2016 RECREATION BALLOT INFORMATION



Howell Area Parks and Recreation Authority

Goals

To obtain stable financial funding that is not relying on the local units of government to continue as the main funding source which can be withdrawn at any time.

To provide quality recreational programs and activities at an affordable cost for the residents of our community.

Plans

To obtain, through a millage election, the funding required to continue to offer and expand current programs along with maintaining and improving existing facilities, all of which are 40 to 50 years old.

Purchase replacement equipment for soccer, volleyball, basketball, tennis, Teen Center and Senior Center along with other areas to be determined.

Complete the purchase or construction of a new critically needed community recreational facility that could potentially house a Senior Center, Teen Center, Administrative offices, Preschool, classrooms, indoor multipurpose courts and fitness areas.

EXAMPLE OF NEW RECREATIONAL FACILITY



sprung Performance Gymsnasiums

Let's talk about the possibilities.

800 528.99

info@sprung.c

EXTERIOR

INTERIOR



EXAMPLE OF NEW RECREATIONAL FACILITY INTERIOR



sprung Performance Gymsnasiums

Let's talk about the possibilities.

800 528.98

info@sprung.o

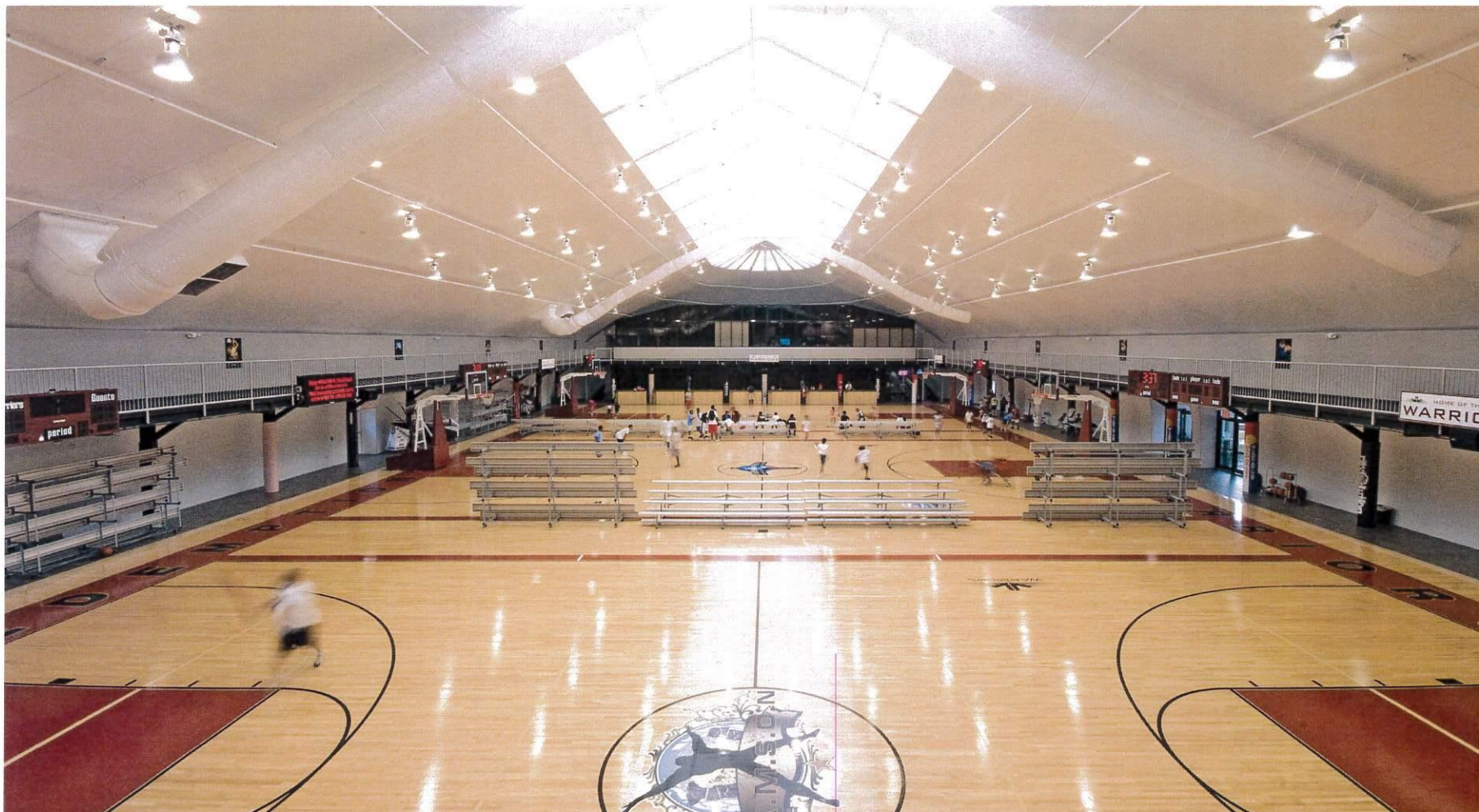

EXAMPLE OF NEW RECREATIONAL FACILITY 2nd FLOOR

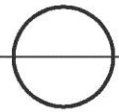
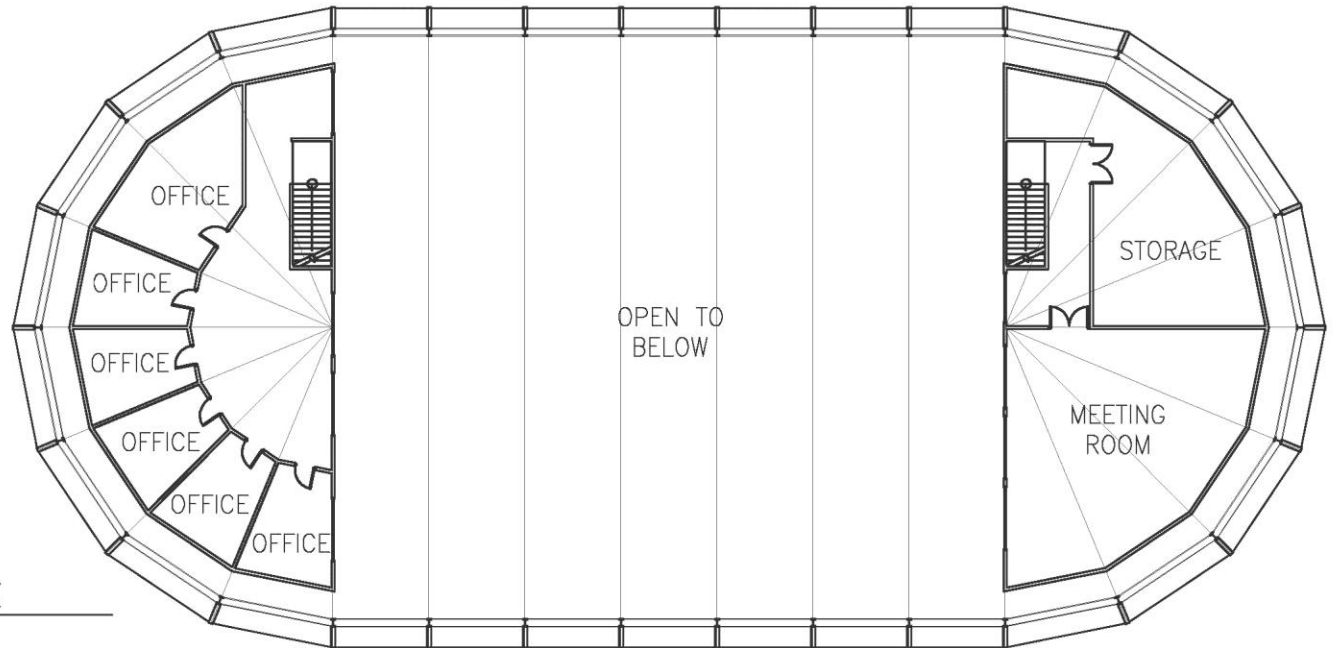

MEZZANINE ABOVE
1"=30'-0"

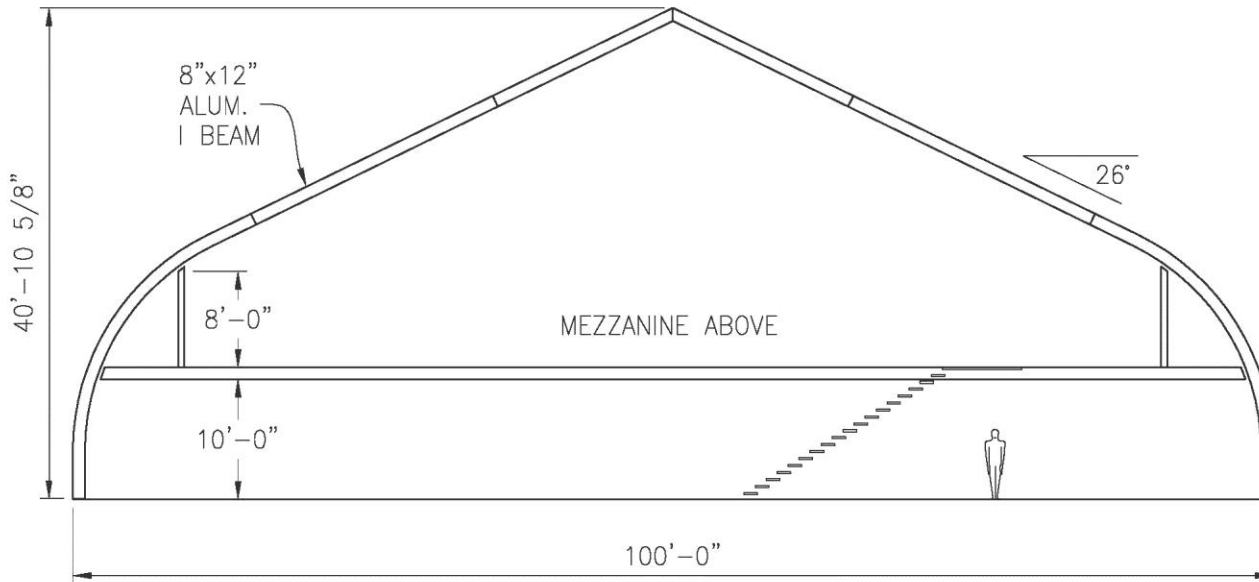

ENHANCED SPREADERS REQUIRED

DRAWING APP

Signature _____

Print Name _____

Date: _____

Confirmation of loads at site per local building de

WIND: q50 _____

SNOW: Ss _____

SNOW: Sr _____

Initial _____

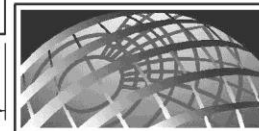

SPRUNG PERFORMANCE
100.0' x 205

DATE _____ SCALE _____

EXAMPLE OF NEW RECREATIONAL FACILITY FEATURE OPTIONS

Sprung Structures

www.sprung.com

After carefully considering a number of building alternatives, it was determined that the Sprung structure technology would be an ideal building envelope to accommodate a wide range of needs and applications.

Within a few short months, a fully insulated 130' x 290' Sprung structure was erected featuring Kynar desert tan and Brownstone red membrane.

Features include:

Administration offices:

Reception area
Directors office
File clerk office
Accountant office
Maintenance supervisor office
Board room

Nutrition center:

Sandwich prep station
Deli meat slicer
Sandwich press
Coffee maker
Cooler
Soup warmer
Stove
Fridge

Library

Elders center:

1,000 square feet
Couches
Table and chairs
T.V.
Washroom
Storage

Youth center:

1,000 square feet
Internet outlets
Table and chairs

Women's public washrooms:

12 regular stalls
2 handicap stalls,
1 w/baby change table
7 sinks
3 hand dryers

Gymnasium:

12,000 square feet
High school size full court
2 elementary size half court
Bleacher seating capacity 804
Jumbo tron and sound system
First aide room
4 change rooms
1 referee room
1 women's change room

Men's public washroom:

1 handicap stall
w/baby change table
1 regular stall
4 urinals
3 sinks
2 hand dryer

Weight room:

1,392 square feet
2 vibration plates
2 skate slide board for 12 yrs and under
Power skating board 13 yrs +
2 Treadmill
2 Elliptical
2 Spin cycle bikes stationary
21 Weight training cages
w/work benches
Dumb bell tree
w/weights 5lbs to 35lbs
Olympic bench press stand
Exercise mats
Sauna seats 4-6 people

Handicap lift:

1,400 lb capacity
Holds 5-6 people

NEW RECREATIONAL FACILITY LOCATION WILL BE



WITHIN A FIVE MILE RADIUS OF DOWNTOWN HOWELL

Cost/Value

How much are we asking you to invest in recreation?

.75 mill for 5 years.

How much will this investment in recreation cost an average household?

On a \$ 200,000 home with a taxable value of \$ 100,000 the resident will pay an extra \$ 75.00 per year. This breaks down to \$ 6.25 per month which is \$ 1.44 a week or 21 cents per day. Less than the cost of 1 cup of coffee per week.

What do voters get from their 21 cents per day investment in recreation?

A new community recreational facility that could potentially house a Senior Center, Teen Center, Administrative offices, Preschool, classrooms, indoor multipurpose courts and fitness areas.

Continuation and expansion of affordable recreational programs and activities to promote health & wellness for ages 2 to 102.

2016 APPROVED BUDGET

2016 BUDGETED REVENUES

2016 BUDGETED EXPENSES

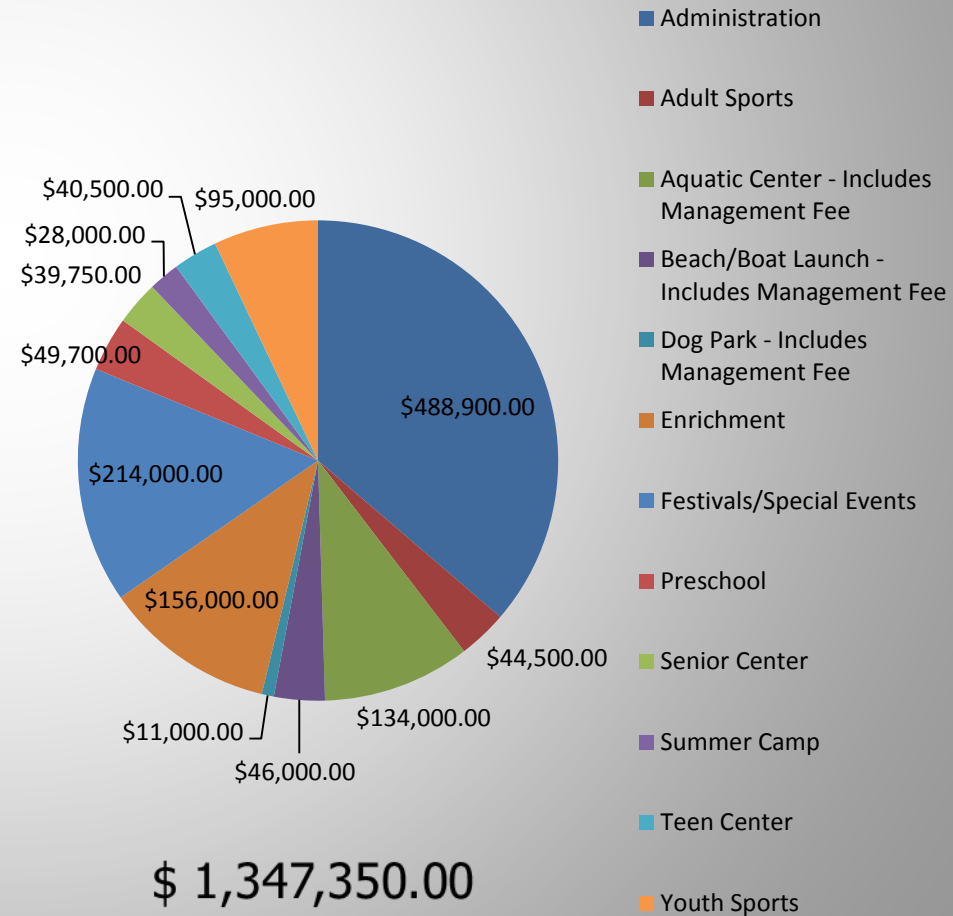
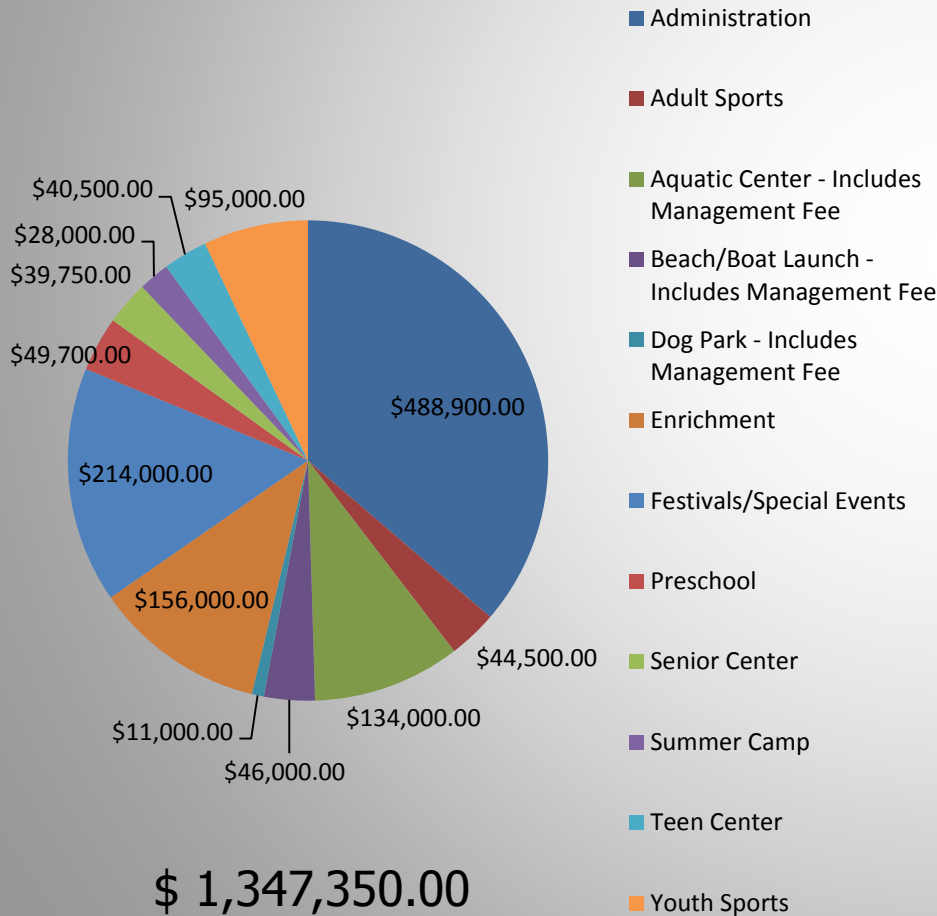

2017 PROJECTED REVENUES

\$ 2,400,000.00

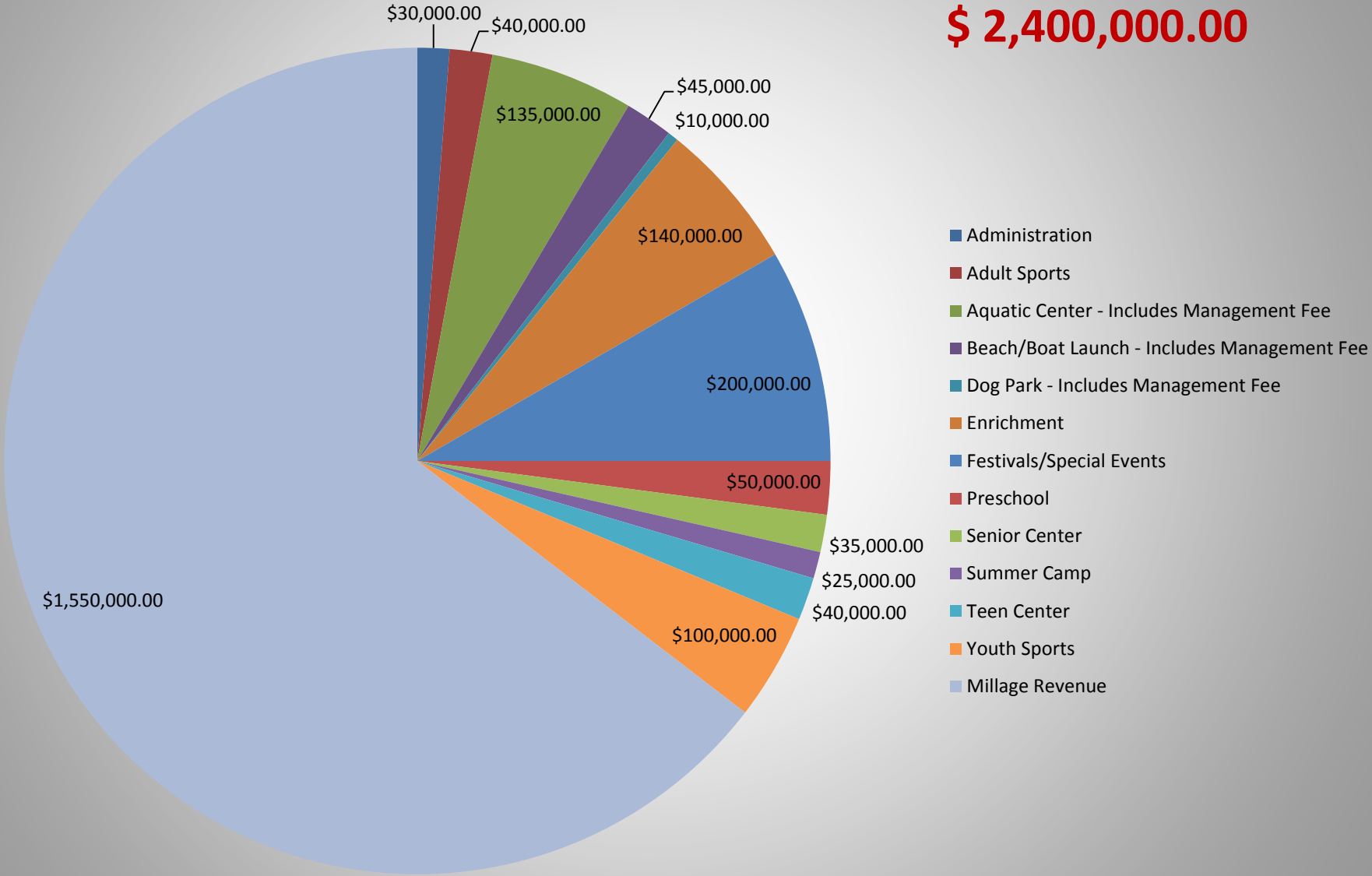

2017 PROJECTED EXPENSES

\$ 2,400,000.00

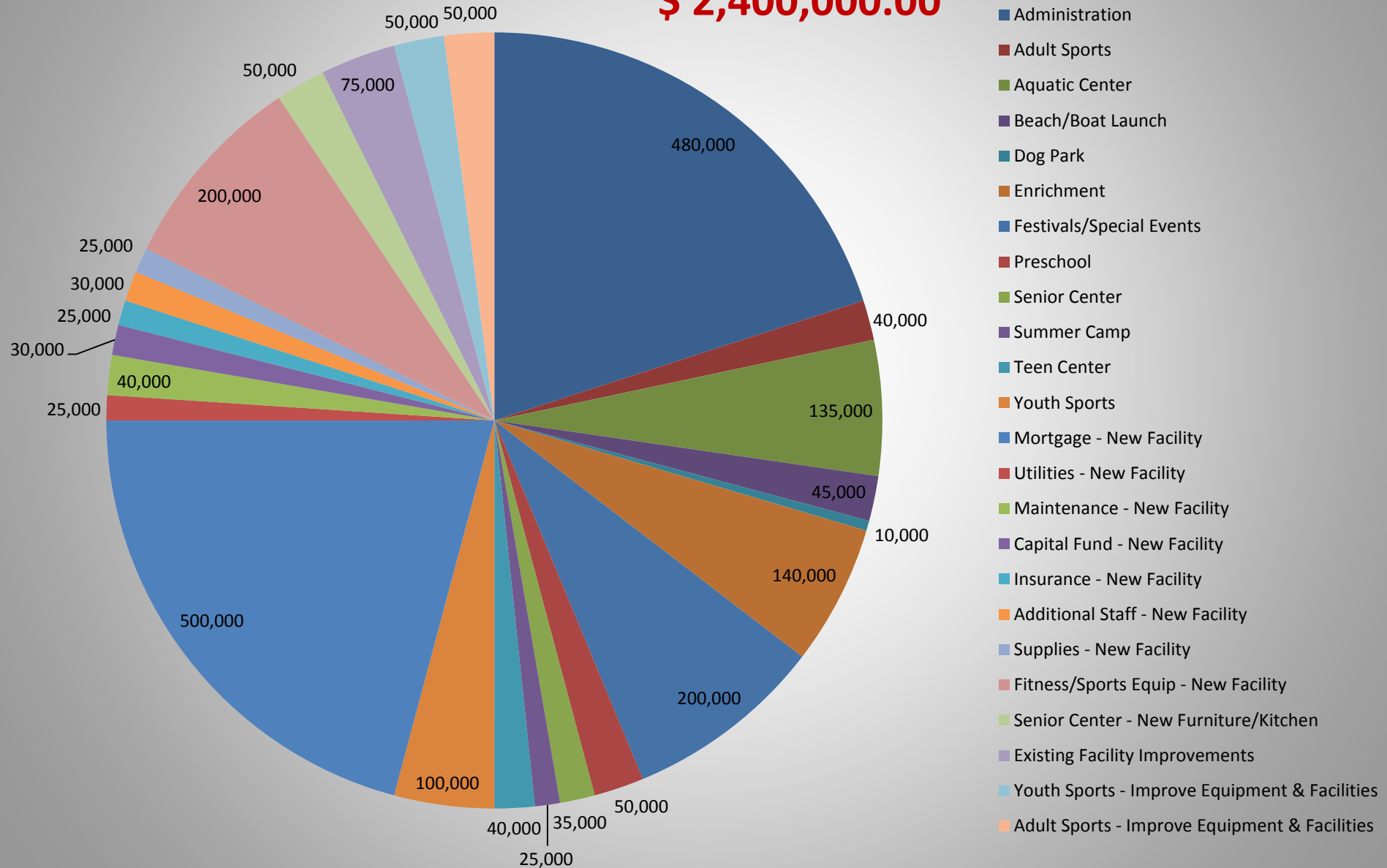

MILLAGE PROJECT ESTIMATED TIMELINE				
DESCRIPTION		START DATE	END DATE	
BUILDING SITE SEARCH - 5 MILE RADIUS OF CENTRAL HOWELL		6/1/2016	12/31/2016	
MILLAGE PASSES		8/2/2016	8/2/2016	
NEW RECREATIONAL FACILITY PROJECT PLANS		8/3/2016	12/31/2016	
NEW RECREATIONAL FACILITY DESIGN		12/31/2016	2/28/2017	
EXISTING RECREATIONAL EQUIPMENT EVALUATION		3/1/2017	4/30/2017	
EXISTING RECREATIONAL FACILITIES PROJECT PLANS		3/1/2017	5/31/2017	
NEW RECREATIONAL FACILITY CONSTRUCTION		4/1/2017	8/30/2017	
REPLACEMENT OF RECREATIONAL EQUIPMENT		5/1/2017	7/31/2017	
RECREATIONAL FACILITY DEDICATION			9/1/2017	
EXISTING RECREATIONAL FACILITIES PROJECTS		6/1/2017	12/31/2017	

Ballot Information

www.howellrecreation.org/ballot

QUESTIONS? EMAIL: HAPRADIR@GMAIL.COM